

# Premier II Keypad

## PI80-Nx Installation



### FEATURES

- Battery: Accessible via a drawer at the keypad base
- Finishes: Black Velvet or Bright Chrome (ABS), Satin Chrome (metal)
- Enhanced Visibility: Built-in LED lights for use in low-light conditions

### DIMENSIONS / MOUNTING INSTRUCTIONS

Cable hole diameter: 3/8" (.953mm) minimum

**The hole must be properly deburred to avoid cable damage**

The PI80 may be mounted on horizontal (9 & 3 o'clock) or vertical (12 & 6) studs. Affix the two #8-32 (or M4) mounting studs to the safe door. Pull down the battery drawer at the bottom of the keypad housing. Feed the cable through the cable/spindle hole on the safe door, then slide the keypad over the #8-32 (or M4) mounting studs and push down until it snaps on with a distinct "click." Insert a 9V battery and close the battery drawer.

Use ONLY Energizer or Duracell Alkaline or Lithium 9 Volt batteries.

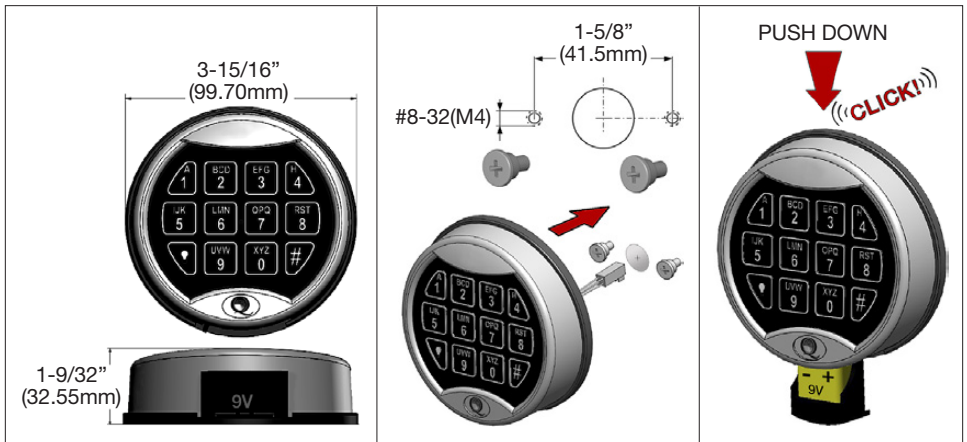

To view our full line of products, Warranty and other Instruction Manuals



**PI80-Nx Works With:**

**UR20**  
Universal  
RotoBolt



**EM20**  
Large  
RotoBolt



**EM30**  
MotorDrive  
Lock



QSecurityProducts.com

Nicholasville, Kentucky, USA 40356 • 859.241.2063

Premier II PI80-Nx INSTALLATION • Rev. 2603 • © 2026 QSecurity Industries